

Immaculately well-kept ground floor flat with a communal garden within a cul-de-sac. Located just off North Circular Road, providing easy access to the local schools, bars and restaurants, along with all the other amenities and transport links. Call now to book your exclusive viewing slot.

Key features

- Double Bedroom
- Lounge with a Fire Feature
- Communal Garden
- Bathroom with a Seperate WC
- Cul-de-sac Location
- Excellent Transport Links
- Available Immediately

Guide Price: £1,150 - £1,350 PCM

Spacious ground floor apartment within a cul-de-sac benefiting from a good-sized lounge with a fire feature, a well-equipped kitchen, a double bedroom, a two-piece bathroom suite and a separate WC. There is also access to a communal lawn garden. Offered furnished.

Basing Way is a short distance away from Finchley Central and Mill Hill East (Northern Line) underground stations providing you with direct links to the City centre. Very close to nearby sports clubs and outdoor leisure areas. Available immediately. Call now to arrange your exclusive viewing slot.

Property Details:

Reception: 15'55 x 12'39 (5.97m x 4.65m)

Laminate flooring, fire feature, double radiator, front aspect double glazed windows, 3x 2-seater leather sofas, coffee table, storage cabinet

Basing Way, Finchley, London N3

Guide Price: £1,150 - £1,350 PCM

 1  1  1

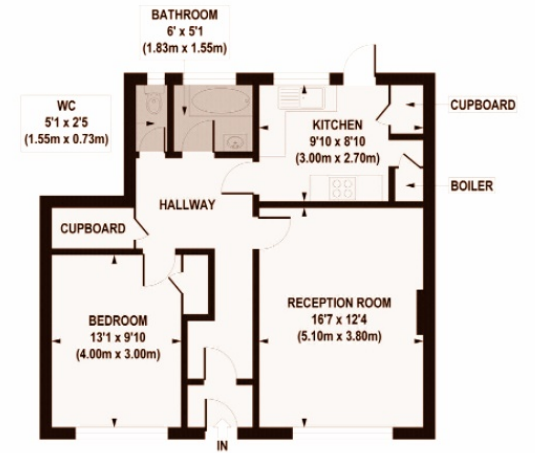
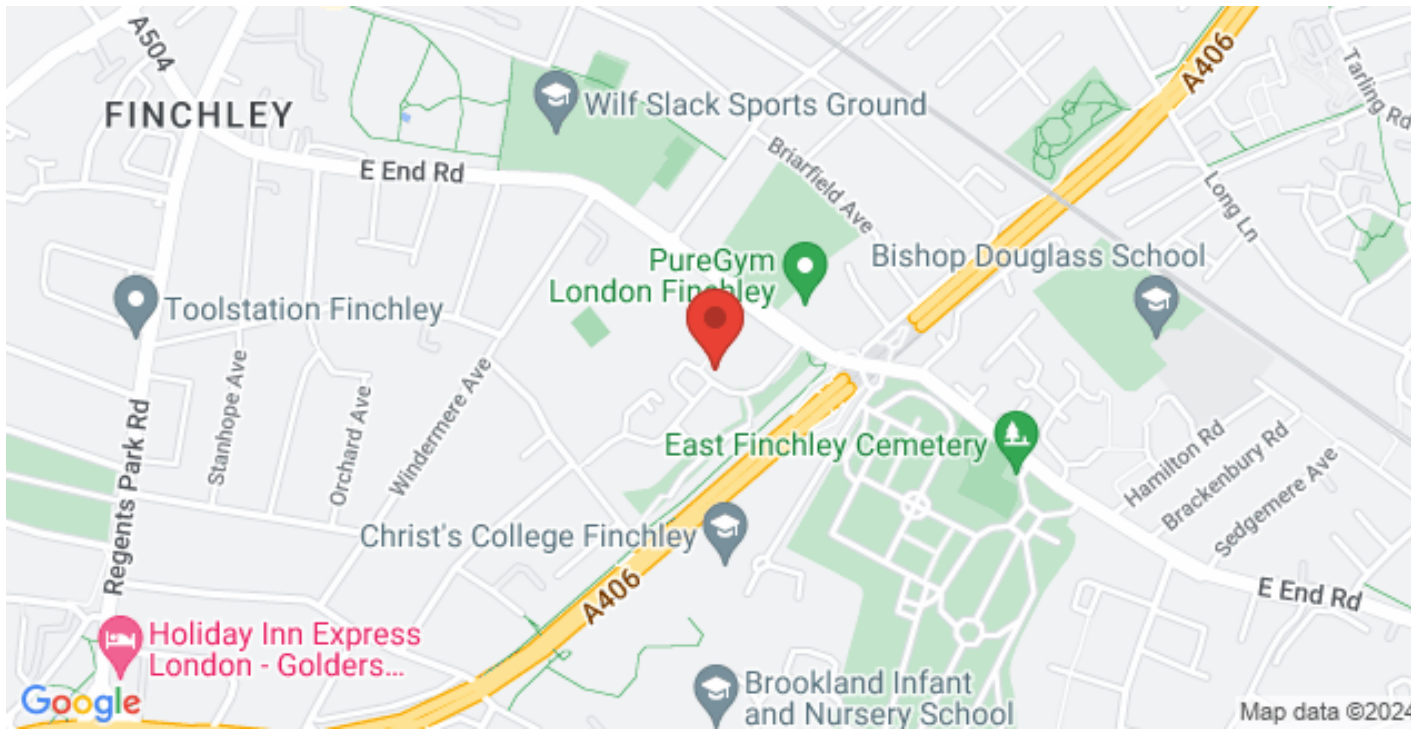

1 1 1 1



Basing Way, Finchley, London N3

020 3422 2333 020 3422 2333

hello@estateology.com

25 Roman Road, Bethnal Green, London, E2 0HU

29th Floor, One Canada Square, Canary Wharf, London, E14 5DY

© 2024 Estateology Company registration no. 9628198. Registered office: 555-557 Cranbrook Road, Gants Hill, Ilford, Essex, IG2 6HE

We have prepared these property particulars as a general guide to a broad description of the property. They are not intended to constitute part of an offer or contract. We have not carried out a structural survey and the services, appliances and specific fittings have not been tested. All photographs, measurements, floorplans and distances referred to are given as a guide only and should not be relied upon for the purchase of carpets or any other fixtures or fittings. Lease details, service charges and ground rent (where applicable) and council tax are given as a guide only and should be checked and confirmed by your Solicitor prior to exchange of contracts. The copyright of all details, photographs and floorplans remain exclusive to Estateology.