

QUIET Cul-de-Sac LOCATION !!! Three bedroom (NO LOUNGE) semi-detached house in the heart of trendy Stepney Green with its own outdoor space. Accommodation with character in one of London's hottest postcodes. Available 5th July. Call now to arrange your exclusive viewing slot.

## Key features

- Three Bedrooms
- NO LOUNGE
- Fitted Kitchen
- 3 Piece Bathroom
- Mile End Park
- Private Garden
- Parking for 2 Cars
- Stepney Green Station
- Whitechapel Station
- Available 5th July

Guide Price: £1,950 - £2,200 PCM



Three bedroom (NO LOUNGE) semi-detached house positioned within a cul de sac, located moments from Stepney Green Underground Station and Whitechapel Station.

Recently refurbished and presented in a very good decorative order throughout. The property comprises generously proportioned bedrooms, modern fitted kitchen and a three piece family bathroom. Further benefits include private driveway big enough to accommodate 2 cars and private rear garden.

Excellent transport links via Stepney Green Underground station as well

# Hayfield Yard, Stepney Green, London, E1

Guide Price: £1,950 - £2,200 PCM

 3  1  2  1



3 1 2 1

# Hayfield Yard, Stepney Green, London, E1

020 3422 2333 020 3422 2333

hello@estateology.com

- 25 Roman Road, Bethnal Green, London, E2 0HU
- 29th Floor, One Canada Square, Canary Wharf, London, E14 5DY

© 2024 Estateology Company registration no. 9628198. Registered office: 555-557 Cranbrook Road, Gants Hill, Ilford, Essex, IG2 6HE

We have prepared these property particulars as a general guide to a broad description of the property. They are not intended to constitute part of an offer or contract. We have not carried out a structural survey and the services, appliances and specific fittings have not been tested. All photographs, measurements, floorplans and distances referred to are given as a guide only and should not be relied upon for the purchase of carpets or any other fixtures or fittings. Lease details, service charges and ground rent (where applicable) and council tax are given as a guide only and should be checked and confirmed by your Solicitor prior to exchange of contracts. The copyright of all details, photographs and floorplans remain exclusive to Estateology.

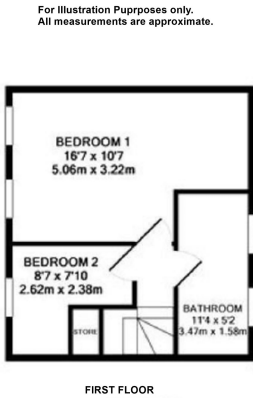
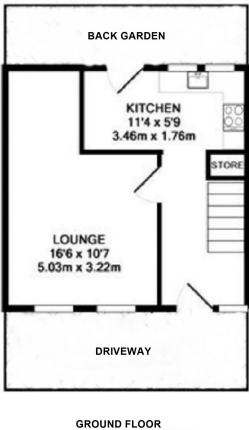

For Illustration Purposes only.  
All measurements are approximate.