



PREPARE TO BE WOWED !! VIDEO TOUR AVAILABLE. Guide Price: £2,250 - £2,550 PCM. Stunning three bedroom flat in the heart of Bethnal Green and within walking distance to trendy Columbia Road and Shoreditch triangle. Recently refurbished to a very high standard, featuring a spacious lounge, luxury kitchen / diner, two 3 piece shower suites with an en-suite to master bedroom and much more. Excellent transport links and access to local amenities and trendy bars and restaurants this area has to offer. Call us now to book your exclusive viewing slot.

Key features

- Three Double Bedrooms
- Spacious Lounge
- Two 3 Piece Shower suites
- En-suite to Master Bedroom
- Luxury Kitchen / Diner
- Bethnal Green Station
- Shoreditch High Street Station
- Available 19th May
- Recently Refurbished
- Columbia Road Market and Shoreditch Triangle

Guide Price: £2,250 - £2,550 PCM.

Stunning three bedroom split-level flat in the heart of Bethnal Green, boasting a spacious lounge, luxury fitted kitchen large enough to dine in, 2 three piece shower suites as well en-suite to master bedroom, double glazed windows and wood laminate flooring throughout.

Located moments away from Columbia Road, which is home to the

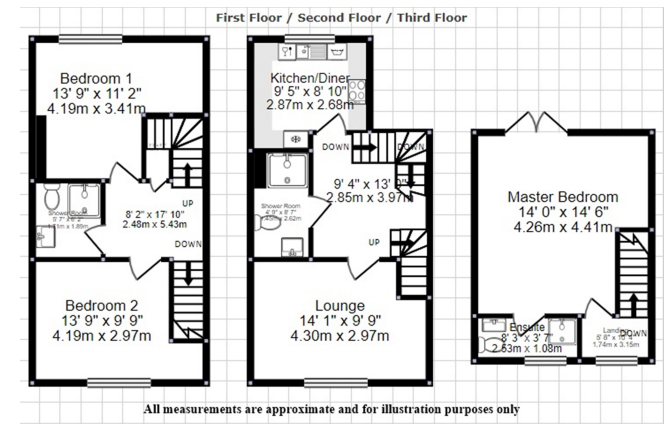

3 1 1 1

Bethnal Green Road, Bethnal Green, London E2

ESTATEOLOGY

020 3422 2333 020 3422 2333

hello@estateology.com

- 25 Roman Road, Bethnal Green, London, E2 0HU
- 29th Floor, One Canada Square, Canary Wharf, London, E14 5DY

© 2024 Estateology Company registration no. 9628198. Registered office: 555-557 Cranbrook Road, Gants Hill, Ilford, Essex, IG2 6HE

We have prepared these property particulars as a general guide to a broad description of the property. They are not intended to constitute part of an offer or contract. We have not carried out a structural survey and the services, appliances and specific fittings have not been tested. All photographs, measurements, floorplans and distances referred to are given as a guide only and should not be relied upon for the purchase of carpets or any other fixtures or fittings. Lease details, service charges and ground rent (where applicable) and council tax are given as a guide only and should be checked and confirmed by your Solicitor prior to exchange of contracts. The copyright of all details, photographs and floorplans remain exclusive to Estateology.