



ESTATEOLOGY

Bevin House, Butler Street, Bethnal Green, London E2

Fixed Price: £370,000 L/H

2 1



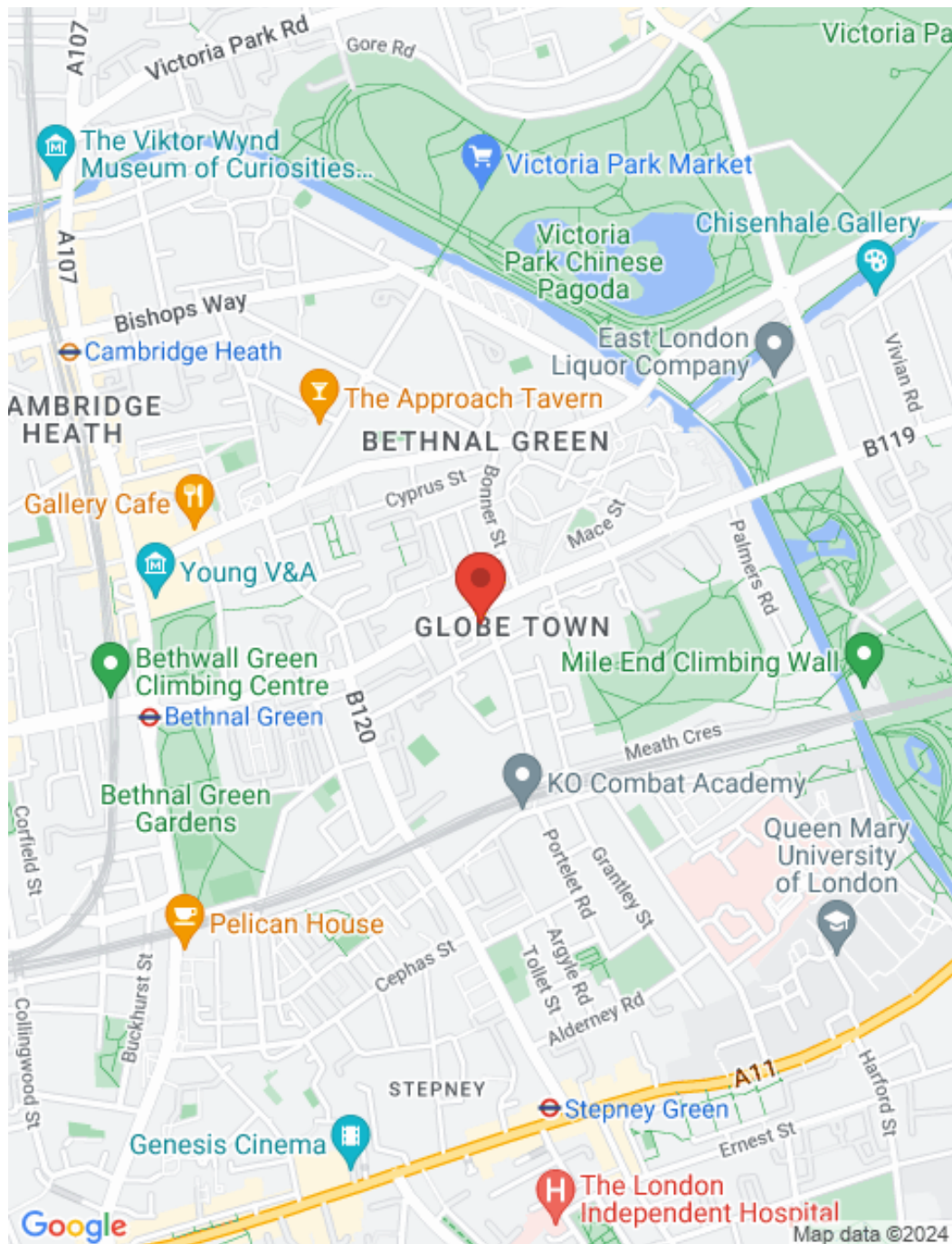

Key features

Location, Location, Location !!! Bright and airy, two bedroom second floor apartment with a South facing aspect within a purpose built block located within the heart of trendy Bethnal Green. Ideal first time purchase for city workers in one of London's hottest postcodes.

- 2 Good Size Bedrooms
- Spacious Reception Room
- Private Balcony
- South Facing Aspect
- Bethnal Green Station
- Separate Kitchen
- 2 Piece Bathroom/Separate WC
- Gas Central Heating

Energy Efficiency Rating

Very energy efficient - lower running costs

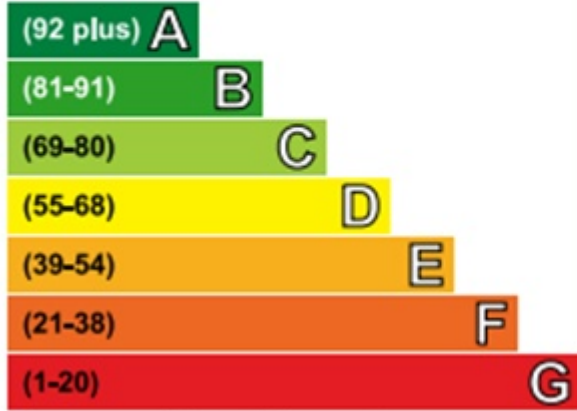

Not energy efficient - higher running costs

Current	Potential
68	80

ESTATEOLOGY

☎ 020 3422 2333 ☎ 020 3095 2333

✉ hello@estateology.com

📍 25 Roman Road, Bethnal Green, London, E2 0HU

📍 29th Floor, One Canada Square, Canary Wharf, London, E14 5DY

© 2024 Estateology Company registration no. 9628198. Registered office: 555-557 Cranbrook Road, Gants Hill, Ilford, Essex, IG2 6HE

We have prepared these property particulars as a general guide to a broad description of the property. They are not intended to constitute part of an offer or contract. We have not carried out a structural survey and the services, appliances and specific fittings have not been tested. All photographs, measurements, floorplans and distances referred to are given as a guide only and should not be relied upon for the purchase of carpets or any other fixtures or fittings. Lease details, service charges and ground rent (where applicable) and council tax are given as a guide only and should be checked and confirmed by your Solicitor prior to exchange of contracts. The copyright of all details, photographs and floorplans remain exclusive to Estateology.

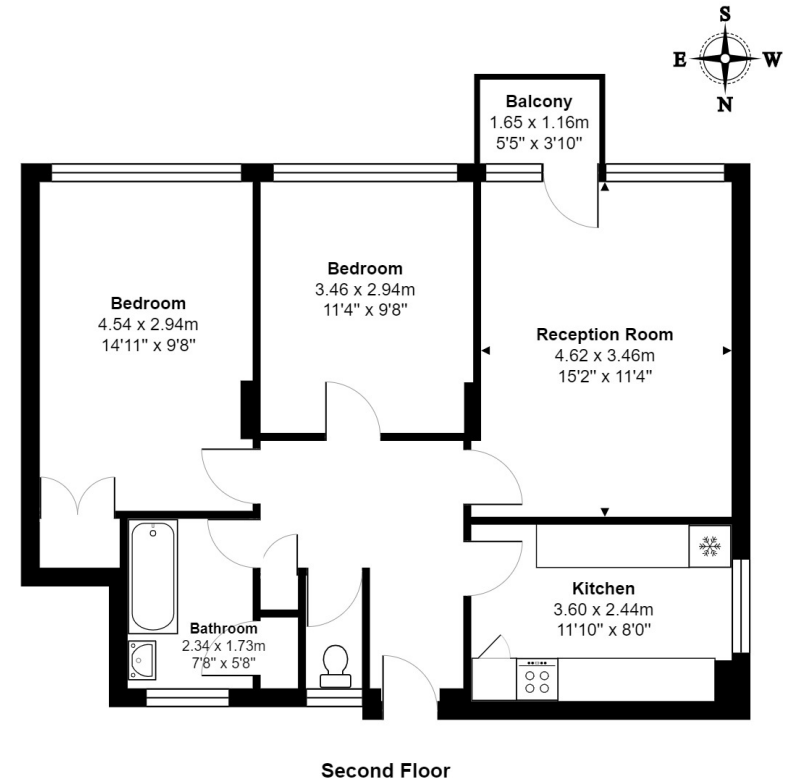

Total Area 65.6 m² ... 706 ft² (excluding balcony)

All measurements are approximate and for display purposes only