



ESTATEOLOGY

Burnham Street, Bethnal Green, London, E2

Guide Price £150,000 - £190,000





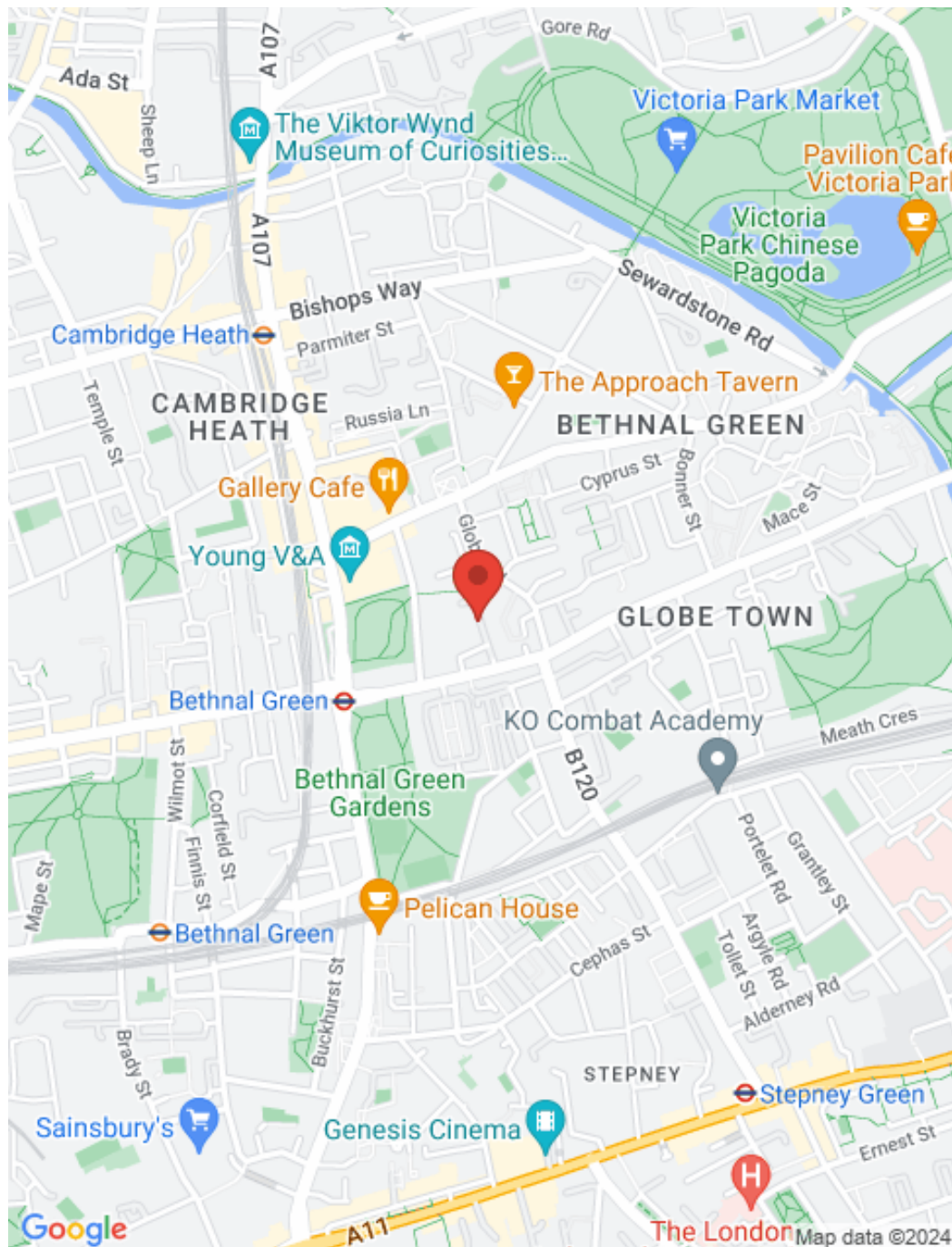

Key features

A truly unique detached studio flat located just 0.2 miles from Bethnal Green underground station. With high ceilings, large windows and access to communal parking. Gateway for the City and Canary Wharf. Property is filled with character. Reasonably priced for first time buyers and investors.

- Unique Detached Studio
- Bethnal Green Tube
- Communal Parking Space
- Close to Local Amenities
- Close to Westfield Shopping Centre
- Close to Liverpool St Station



☎ 020 3422 2333 ☎ 020 3095 2333

✉ hello@estateology.com

📍 25 Roman Road, Bethnal Green, London, E2 0HU

📍 29th Floor, One Canada Square, Canary Wharf, London, E14 5DY

© 2024 Estateology Company registration no. 9628198. Registered office: 555-557 Cranbrook Road, Gants Hill, Ilford, Essex, IG2 6HE

We have prepared these property particulars as a general guide to a broad description of the property. They are not intended to constitute part of an offer or contract. We have not carried out a structural survey and the services, appliances and specific fittings have not been tested. All photographs, measurements, floorplans and distances referred to are given as a guide only and should not be relied upon for the purchase of carpets or any other fixtures or fittings. Lease details, service charges and ground rent (where applicable) and council tax are given as a guide only and should be checked and confirmed by your Solicitor prior to exchange of contracts. The copyright of all details, photographs and floorplans remain exclusive to Estateology.

Museum House

Approximate Gross Internal Area
16.4 sq m / 177 sq ft

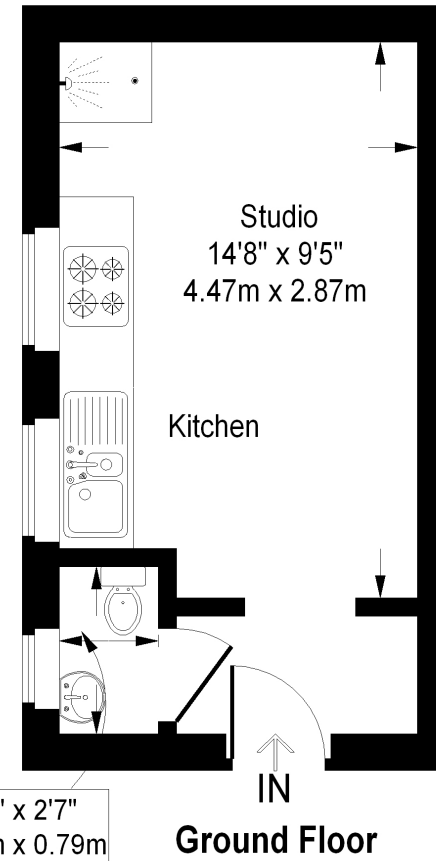

This plan is for layout guidance only. Not drawn to scale unless stated. Windows and door openings are approximate.

Whilst every care is taken in the preparation of this plan, please check all dimensions, shapes and compass bearings before making any decisions reliant upon them. (ID:222257)