





 ESTATEOLOGY

Padstow House, Three Colt Street, London E14

Guide Price: £375,000 - £425,000

 3  0







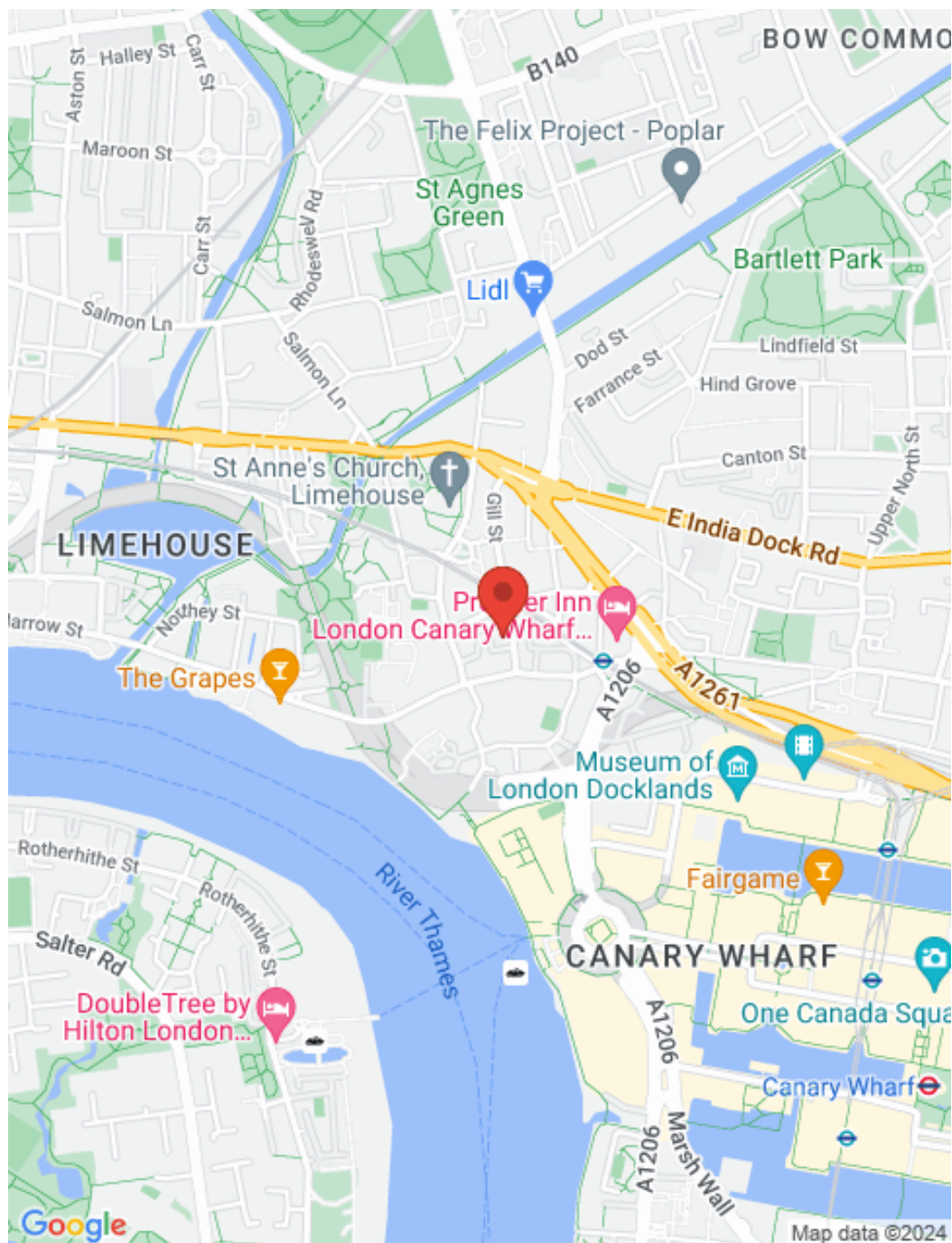

## Key features

Three bedroom flat with host of features including laminate wood flooring throughout, modern fitted kitchen, three piece family bathroom, located within easy reach of Westferry and Limehouse DLR and Canary Wharf. Call now to arrange a viewing.

- Three Bedroom
- First Floor Flat
- Bright & Spacious
- Lounge / Diner
- Neutral Decor
- Close to Amenities
- Westferry DLR
- Limehouse DLR
- Secure entry system
- Call to arrange viewing



☎ 020 3422 2333 ☎ 020 3095 2333

✉ hello@estateology.com

📍 25 Roman Road, Bethnal Green, London, E2 0HU

📍 29th Floor, One Canada Square, Canary Wharf, London, E14 5DY

© 2024 Estateology Company registration no. 9628198. Registered office: 555-557 Cranbrook Road, Gants Hill, Ilford, Essex, IG2 6HE

We have prepared these property particulars as a general guide to a broad description of the property. They are not intended to constitute part of an offer or contract. We have not carried out a structural survey and the services, appliances and specific fittings have not been tested. All photographs, measurements, floorplans and distances referred to are given as a guide only and should not be relied upon for the purchase of carpets or any other fixtures or fittings. Lease details, service charges and ground rent (where applicable) and council tax are given as a guide only and should be checked and confirmed by your Solicitor prior to exchange of contracts. The copyright of all details, photographs and floorplans remain exclusive to Estateology.

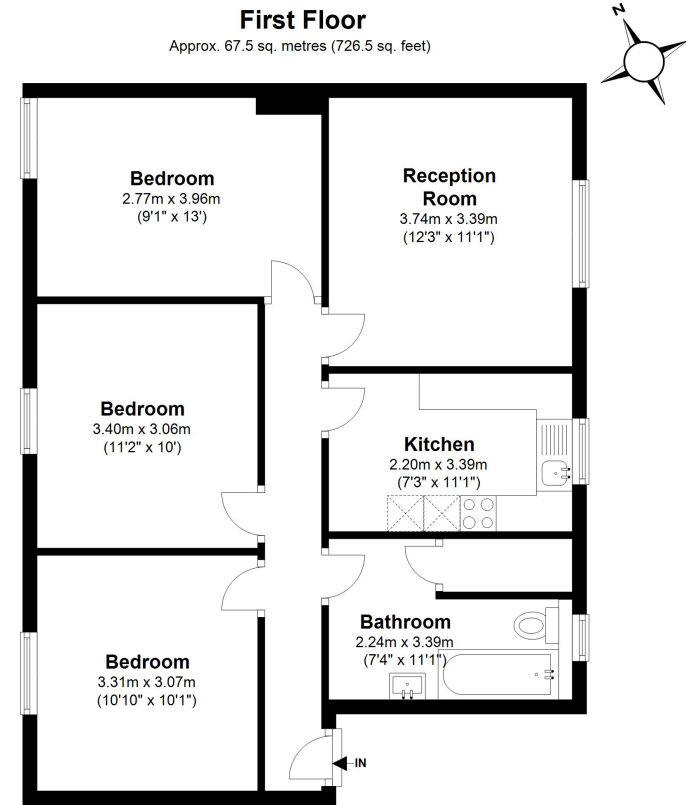

Total area: approx. 67.5 sq. metres (726.5 sq. feet)

While we do not doubt the floor plans accuracy, we make no guarantee, warranty or representation as to the accuracy and completeness of the floor plan. You or your advisors should conduct a careful, independent investigation of the property to determine to your satisfaction as to the suitability of the property for your space requirements.

Plan produced using PlanUp.