



This truly delightful two bedroom mews house arranged over three floors boasting a bright and generous kitchen/living/entertaining space with 2 bathrooms with its own private roof terrace. Close to a wealth of Notting Hill amenities. 5-10 years lease available. Early viewing advised.

Key features

- Fully fitted German kitchen
- 2 x 3 Piece bathroom suite
- Private Roof Terrace
- Notting Hill Gate & Kensington High Street
- Well-proportioned master bedroom
- Excellent transport links
- Set moments from the amenities of Notting Hill Gate
- Air Condition and Wi-Fi included
- 2 bedroom mews house
- Wonderful open plan living / kitchen



LONG LET: Guide Price £6,066 - £7,800 PCM Full Description: A stunning two bedroom mews house occupying approximately 1,225 sq ft arranged over 3 floors is available for long term let, 5 -10 years lease with upfront payments. This truly fantastic two bedroom house with two bathrooms and private roof terrace comes with an entertaining open plan fully fitted kitchen / reception room, with a summer garden, climate control air conditioner and separate WC on the ground floor. The first floor comprises of a master bedroom with a private dressing area leading onto an ensuite 3 piece shower room with doors leading out to the roof terrace from the bedroom and further benefits from a front aspect balcony, underfloor heating and air conditioner. The second floor



2 2 1 2

Rabbitt Row, Kensington, London, W8

ESTATEOLOGY

020 3422 2333 020 3422 2333

hello@estateology.com

- 25 Roman Road, Bethnal Green, London, E2 0HU
- 29th Floor, One Canada Square, Canary Wharf, London, E14 5DY

© 2024 Estateology Company registration no. 9628198. Registered office: 555-557 Cranbrook Road, Gants Hill, Ilford, Essex, IG2 6HE

We have prepared these property particulars as a general guide to a broad description of the property. They are not intended to constitute part of an offer or contract. We have not carried out a structural survey and the services, appliances and specific fittings have not been tested. All photographs, measurements, floorplans and distances referred to are given as a guide only and should not be relied upon for the purchase of carpets or any other fixtures or fittings. Lease details, service charges and ground rent (where applicable) and council tax are given as a guide only and should be checked and confirmed by your Solicitor prior to exchange of contracts. The copyright of all details, photographs and floorplans remain exclusive to Estateology.

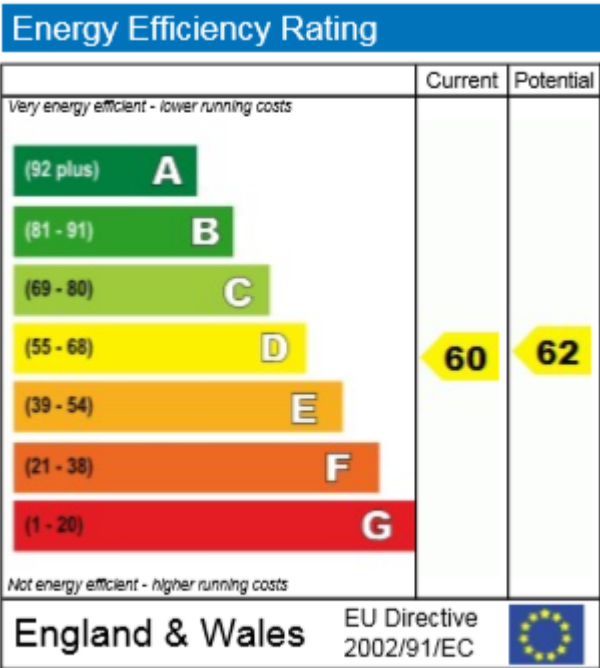
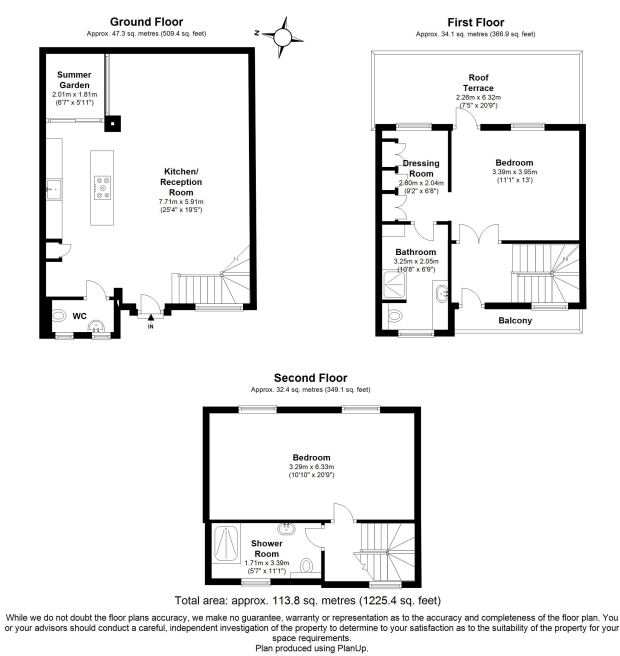

The energy efficiency rating is a measure of the overall efficiency of a home. The higher the rating