

This truly unique detached studio flat is a one-off! Ideally located just 0.2 miles from Bethnal Green underground station or a short walk to Liverpool Street, this studio is filled with character. High ceilings and large factory style windows. High interest expected.

Key features

- Unique Detached Studio
- Bethnal Green Tube
- Factory style windows
- Close to Local Amenities
- Available from 31st March 2016

This truly unique detached studio flat is a one-off! Ideally located just 0.2 miles from Bethnal Green underground station or a short walk to Liverpool Street, this studio is filled with character. High ceilings and large factory style windows which allow for an abundance of natural sunlight to fill the property. Close to local amenities and Bethnal Green tube station. This studio offers, in our opinion a perfect gateway for those who need quick access to central London areas. Ideal for someone looking for a pied a terre with easy access to the city.

Entrance

Via own front door.

Studio

Open plan quirky studio area offers various power points, two south facing large factory style windows filling the room with plenty of light.

Shower cubicle, tiled splash-back, hot and cold shower controls.

WC

Low level flush WC, tiled walls and floor



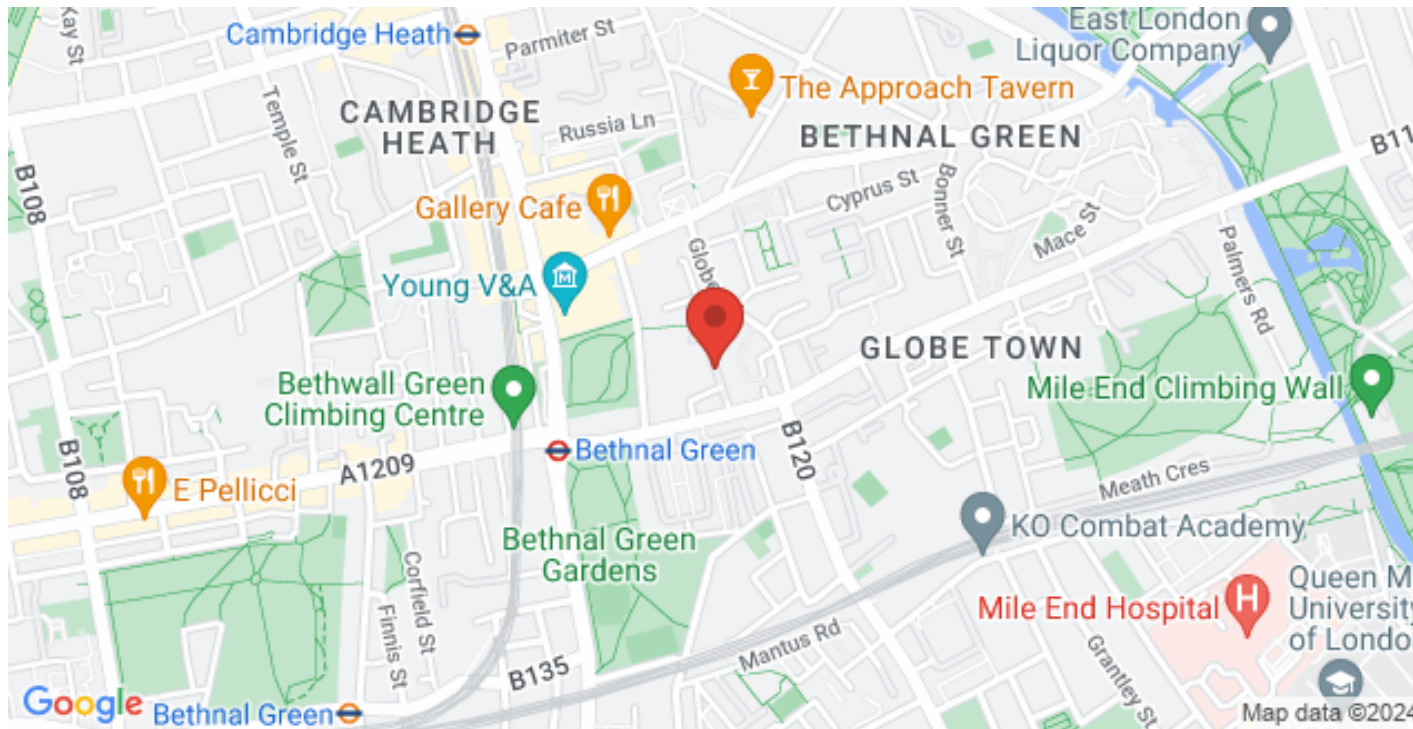

1 1 1 1

Burnham Street, Bethnal Green, London, E2

ESTATEOLOGY

020 3422 2333 020 3422 2333

hello@estateology.com

- 25 Roman Road, Bethnal Green, London, E2 0HU
- 29th Floor, One Canada Square, Canary Wharf, London, E14 5DY

© 2024 Estateology Company registration no. 9628198. Registered office: 555-557 Cranbrook Road, Gants Hill, Ilford, Essex, IG2 6HE

We have prepared these property particulars as a general guide to a broad description of the property. They are not intended to constitute part of an offer or contract. We have not carried out a structural survey and the services, appliances and specific fittings have not been tested. All photographs, measurements, floorplans and distances referred to are given as a guide only and should not be relied upon for the purchase of carpets or any other fixtures or fittings. Lease details, service charges and ground rent (where applicable) and council tax are given as a guide only and should be checked and confirmed by your Solicitor prior to exchange of contracts. The copyright of all details, photographs and floorplans remain exclusive to Estateology.

Museum House

Approximate Gross Internal Area
16.4 sq m / 177 sq ft

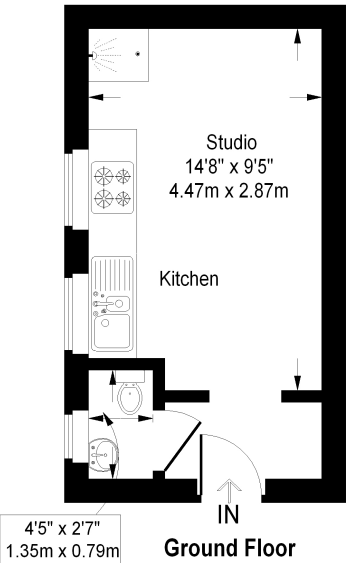

This plan is for layout guidance only. Not drawn to scale unless stated. Windows and door openings are approximate. Whilst every care is taken in the preparation of this plan, please check all dimensions, shapes and compass bearings before making any decisions reliant upon them. (ID:22257)