



Bright and airy spacious two double bedroom apartment available. Located moments from All Saints DLR and the Canary Wharf district. Immediate viewings are highly advised to avoid disappointment.

Key features

- 2 Double Bedrooms
- 2 Bathroom
- Second Floor
- Fitted Kitchen
- Gas Central Heating
- Entry Phone System
- All Saints DLR
- Available Immediately

Well presented two double bed two bath, second floor apartment positioned within a smart residential block moments away from Canary Wharf. Presented in good decorative order throughout, the property comprises master bedroom incorporating an en-suite shower room, a further double bedroom, a three piece bathroom suite. Follett Street is located just off East India Dock Road which hosts a number of local conveniences, however for a more extensive range of shops, bars and restaurants, Canary Wharf is also within close proximity. Transport links include All Saints Station (DLR).

KITCHEN

Fitted kitchen

Gas cooker with Extractor hood

Storage cupboard

Various storage units at eye and base level

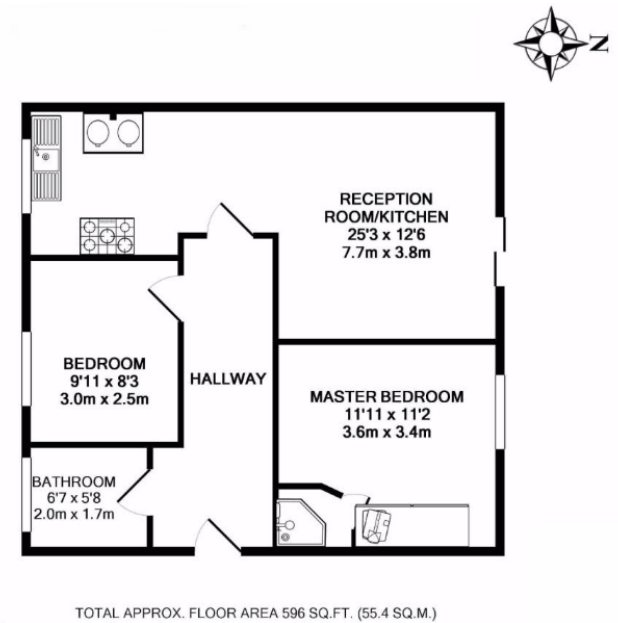
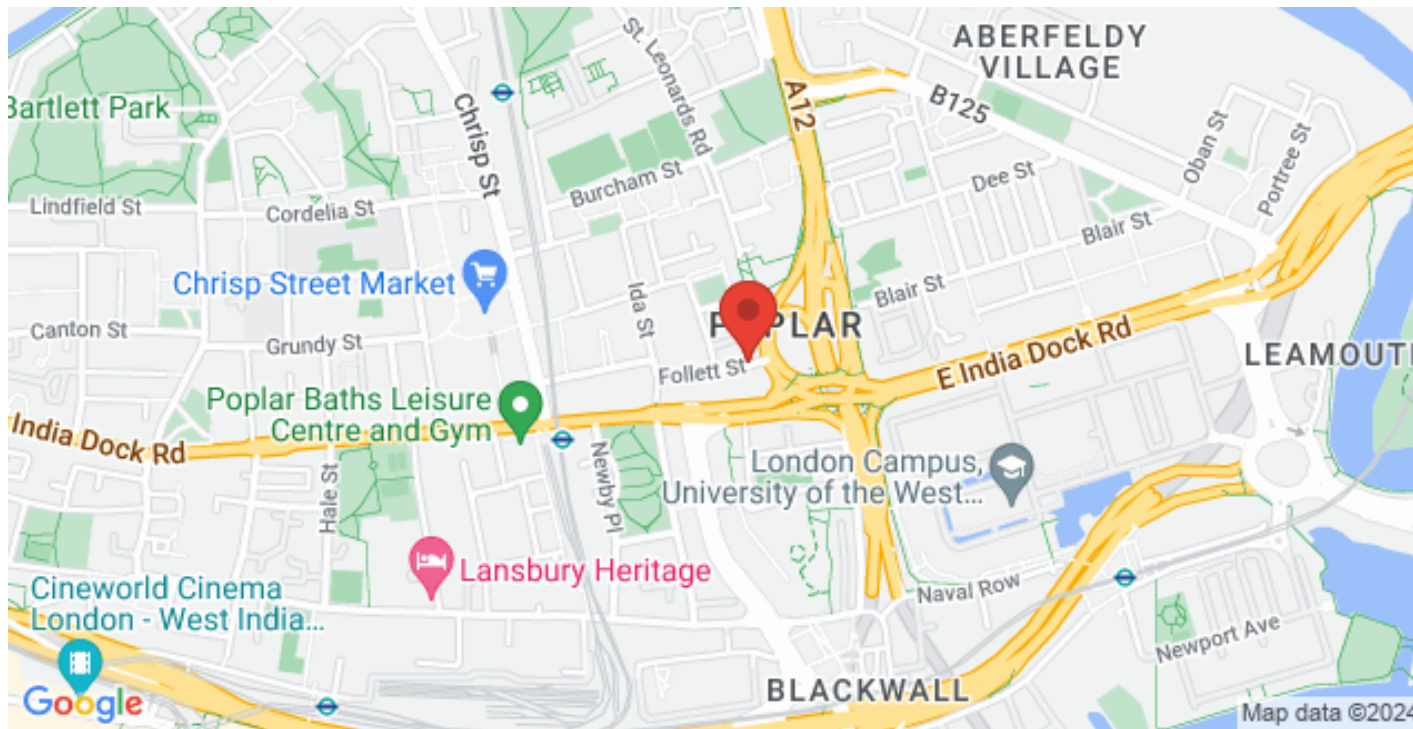

 2
  2
  1
  1

Follet Street, Poplar, London, E14

 ESTATEOLOGY

 020 3422 2333
  020 3422 2333

 hello@estateology.com

 25 Roman Road, Bethnal Green, London, E2 0HU

 29th Floor, One Canada Square, Canary Wharf, London, E14 5DY

© 2024 Estateology Company registration no. 9628198. Registered office: 555-557 Cranbrook Road, Gants Hill, Ilford, Essex, IG2 6HE

We have prepared these property particulars as a general guide to a broad description of the property. They are not intended to constitute part of an offer or contract. We have not carried out a structural survey and the services, appliances and specific fittings have not been tested. All photographs, measurements, floorplans and distances referred to are given as a guide only and should not be relied upon for the purchase of carpets or any other fixtures or fittings. Lease details, service charges and ground rent (where applicable) and council tax are given as a guide only and should be checked and confirmed by your Solicitor prior to exchange of contracts. The copyright of all details, photographs and floorplans remain exclusive to Estateology.